

Modificado

MODIFICACIONES		FECHA
A	Modificado de acuerdo con carta del Ship Control del 28-1-63	28-1-63
B	Modificación de los cascos y escalas	5-10-63

PRINCIPAL CHARACTERISTICS

LENGTH OVER ALL	107.00m - 351' - 4 9/16"
LENGTH BETWEEN P.P.	88.00 - 289' - 6 3/4"
BREADTH MOULDED	16.00 - 52' - 6"
DEPTH TO SHELTER DECK	9.35 - 30' - 5 7/8"
DEPTH TO MAIN DECK	6.70 - 22' - 0"
DEADWEIGHT OPEN SHELTER DECK	4,600 TM - 4,527 TONS
CORRESPONDING DEADWEIGHT	6,467 TM - 21' - 1 1/2"
DEADWEIGHT CLOSED SHELTER DECK	6,100 TM - 6,004 TONS
CORRESPONDING DEADWEIGHT	760 MTK - 25' - 0"
GRADES REWSTER AS OPEN SHELTER DECK	3,000 TONS
GRADES REWSTER AS CLOSED SHELTER DECK	4,408 "
TOTAL HOLD CAPACITY (GRAIN)	300,000 CUR. FT.
FRESH WATER CAPACITY	120,910 m³
FUEL OIL CAPACITY	671.140 "
WATER BALLAST CAPACITY (A TOTAL DOUBLE BOTTOM)	572.63 "
LUBRICATION OIL CAPACITY	23,100 "
R.P.M. MAXIMUM	6,000
R.P.M. MINIMUM	150
TRIAL SPEED AS CLOSED SHELTER DECK (FULLY LOAD CONDITION)	14.5 KNOTS
TRIAL SPEED AS OPEN SHELTER DECK (FULLY LOAD CONDITION)	15.0 "

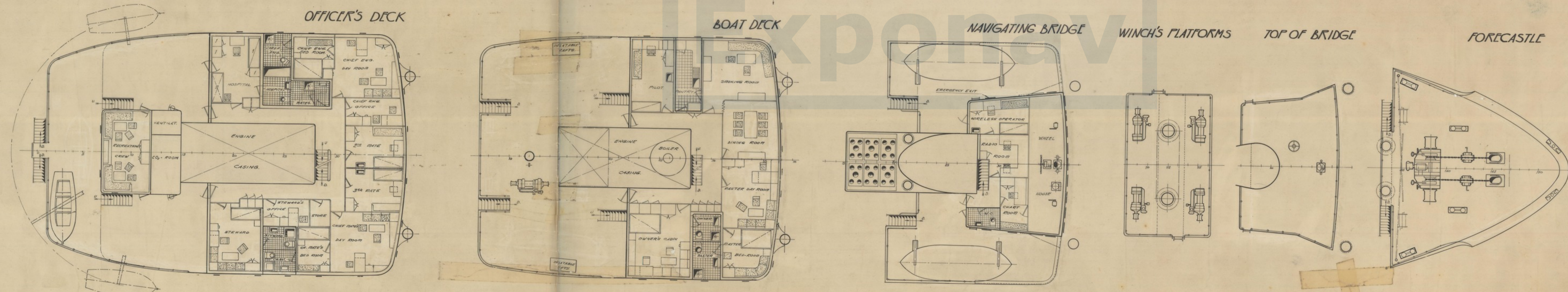

CALCULADO	FECHA 8-11-1961	Gráfica enviada a
DIBUJADO	ORDEN 164-165	BALIDA El Ingeniero Jefe
COMPROBADO	ESCALA 1:100	
Calificado por		
OPEN/CLOSED SHELTER DECKER of 4600/6100 TONS. D.W. GENERAL ARRANGEMENT.		PLANO N.º PR-8804/1 HOJA N.º 1 DE 2 1 2