

CUBIERTA BOTES

CUBIERTA PUENTE

CUBIERTA CASTILLO

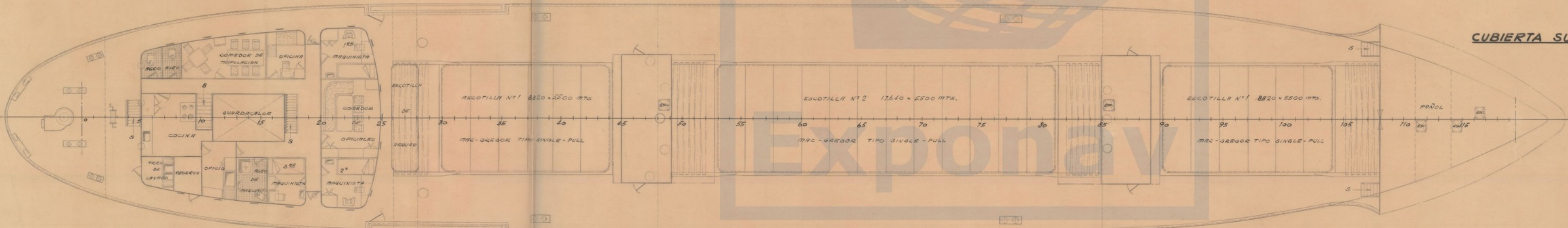
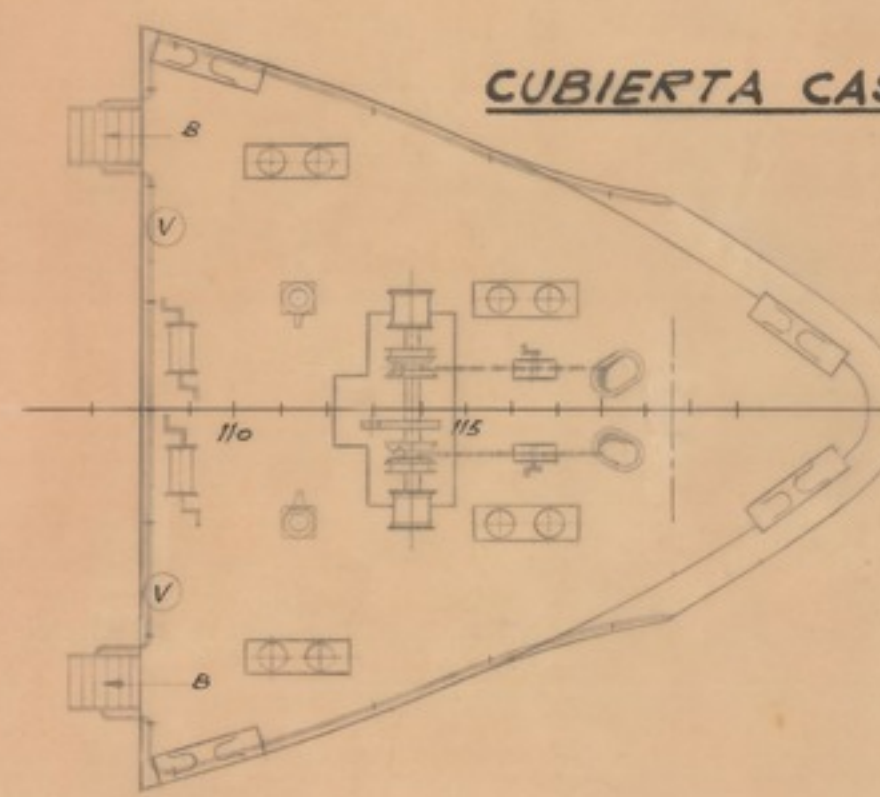
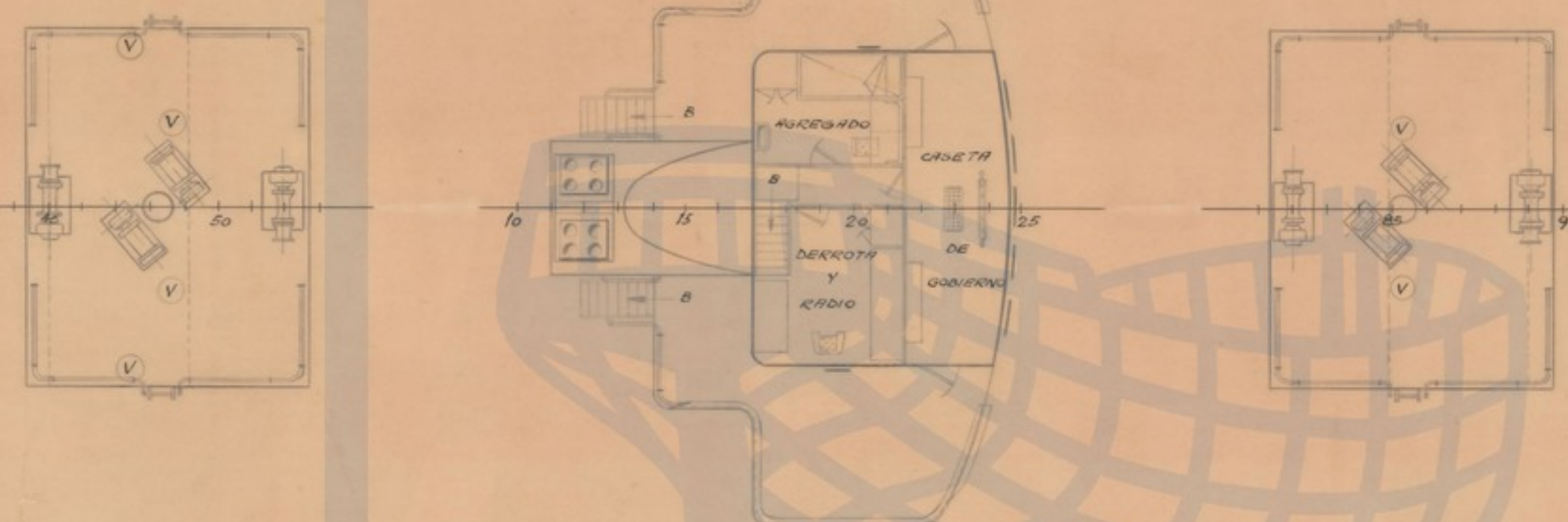
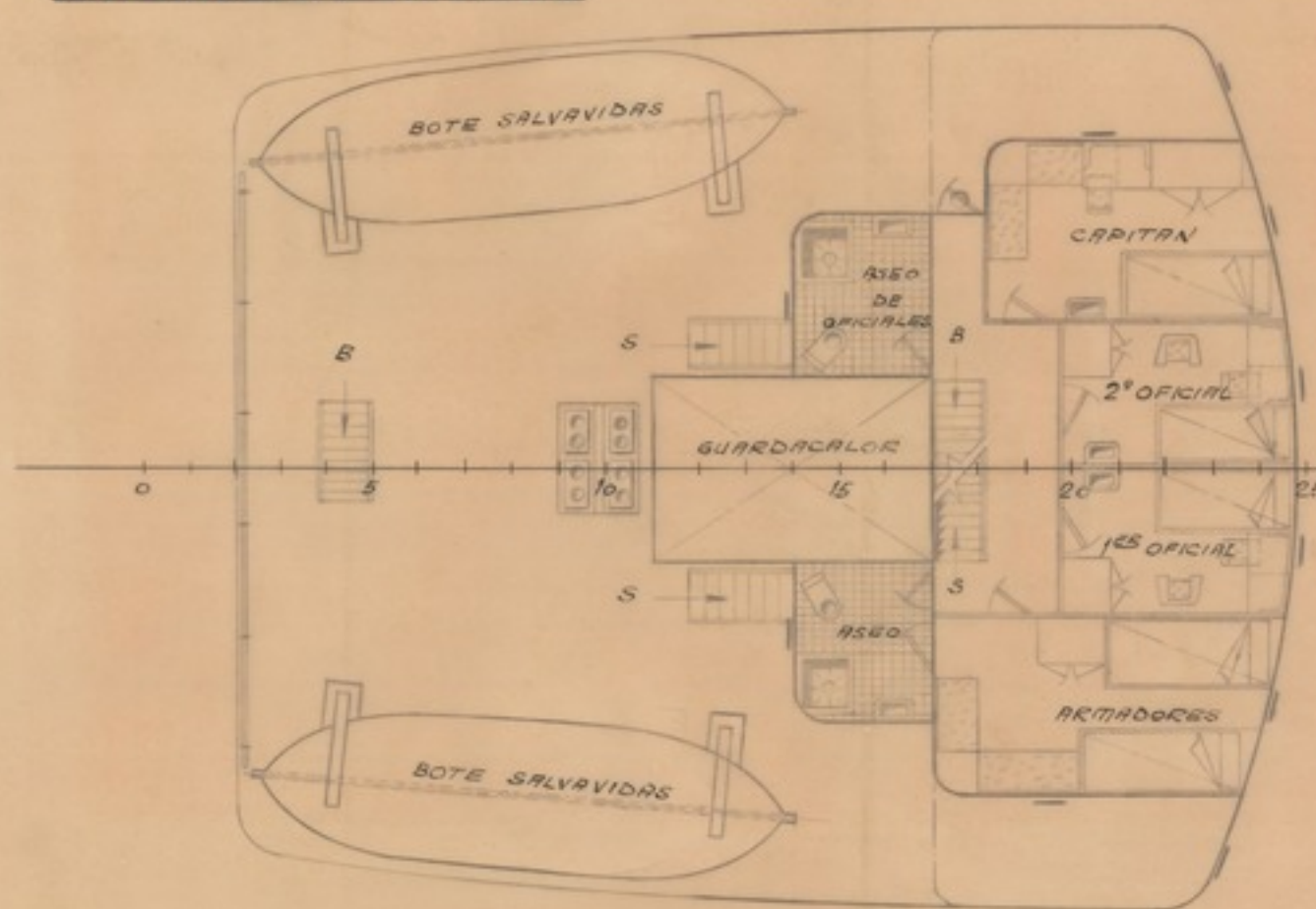

CUBIERTA SUPERIOR

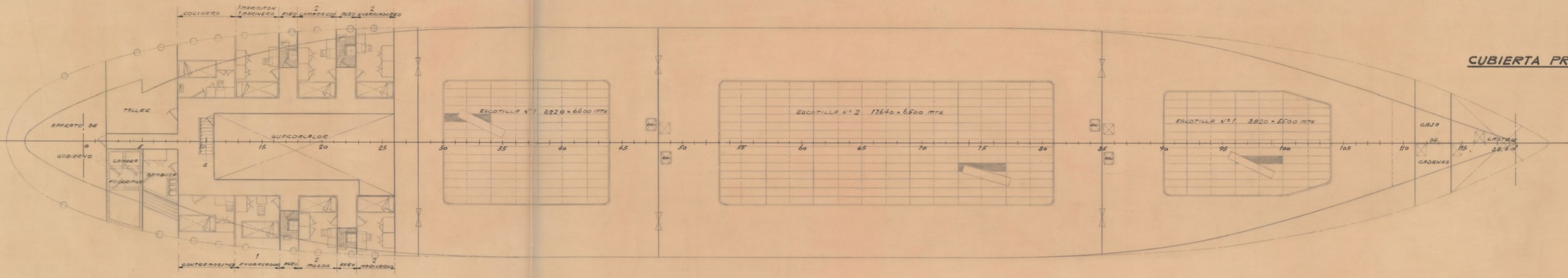

CUBIERTA PRINCIPAL

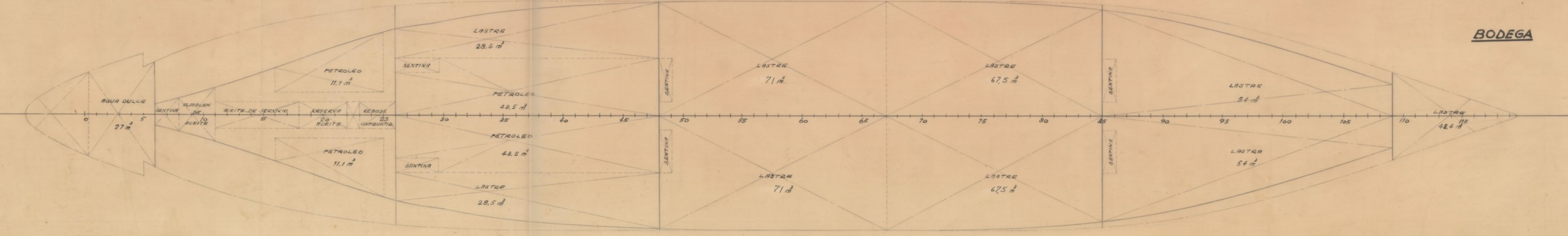

BODEGA

**CARACTERISTICAS**

- ESLORA ENTRE PERPENDICULARES ..... 75,000 mts
- BANCA ..... 12,000 -
- PUNTA A CUBIERTA SUPERIOR ..... 7,000 -
- PUNTA A CUBIERTA PRINCIPAL ..... 4,500 -
- CARGO EN CUBIERTA ..... 4,456 -
- PESO MUERTO ..... 1918 TONS.

CALCULO	FECHA 27-III-44	
DISEÑO	NC-120	
ESCALA	1:100	BALISA 10 Regatare Vela
<b>BUQUE "LAGO SANABRIA"</b>		
<b>DISPOSICION GENERAL</b>		
FR-10804 <small>CONSTRUCCION EN ACERO</small>		